

MF 20 ...

Network Type : UG MV

Mechanical splicing connectors

Description :

- Connectors to be used for aluminium or copper circular stranded cables (XLPE cables).
- Maxi voltage : 42 kV
- Tightening of shear head screws with a standard socket, manually or with an impact gun.
- The shear head breaking off will ever occur in the connector volume (not standing more than 1,5 mm), in order to reduce electrical stress.



Splicing connectors for use in MV underground joints.

- Centred bore.
- Tapered edges.
- Tinned aluminium alloy body and aluminium alloy screws.
- Moisture block barrier in the center.
- Reduced sizes, especially adapted to heat shrinkable and cold shrinkable joints.

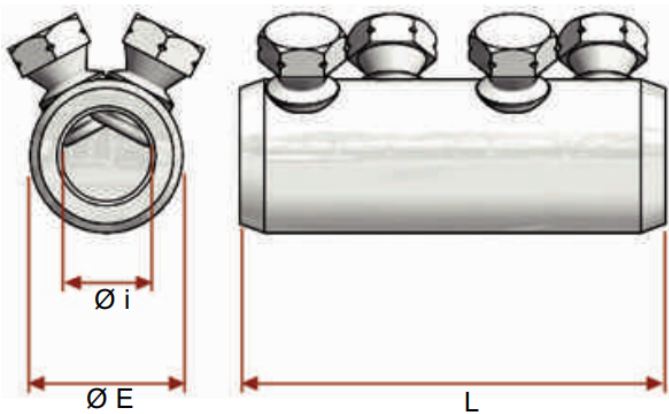

Ref.	Item code	$\varnothing i$	$\varnothing e$	L	Number	Screw	H sur plats (mm)
MF 20/1-2	8969524	13	25	80	2		13
MF 20/2-2	8969529	16	25	90	2		17
MF 20/3D	8969594	20.8	34	97	2		17
MF 20/3D1	8969595	20.8	34	97	2		17
MF 20/3DS	8969596	20.8	34	97	2		17
MF 20/31	8969532	13	25/34	97	2		13/17
MF 20/3,5	8969604	23	37	140	2		22
MF 20/3,5D	8969613	23	37	140	2		22
MF 20/5	8969606	33	50	200	2		22
MF 20/1(25-95)	8969525	-	-	-	-		-
MF 20/2	8969602	-	-	-	-		-
MF 20/2(70-150)	8969523	-	-	-	-		-
MF 20/3,5(185-300)	8969567	-	-	-	-		-



Ref.	Item code	Ø i	Ø e	L	Number	Screw	
							H sur plats (mm)
MF 20/3(120-240)	8969528	-	-	-	-		-
MF 20/4(240-400)	8969527	-	-	-	-		-
MF 20/5(400-630)	8969526	-	-	-	-		-

