

**ML 20 ...**

Network Type : MV-LV

**Mechanical termination Lugs**

**Description :**  
Mechanical termination lugs for connection of underground cables up to 42kV.

- Lugs to be used for aluminium or copper circular stranded cables (XLPE cables).
- Tightening of shear head screws, with a standard socket, manually or with an impact gun.
- The shear head breaking off will ever stay occur in the lug volume (not standing more than 1,5 mm).
- Centred bore. Tapered edge.
- Tinned aluminium alloy body and aluminium alloy screws.
- Reduced sizes, especially adapted to heat shrink and cold shrink terminations.

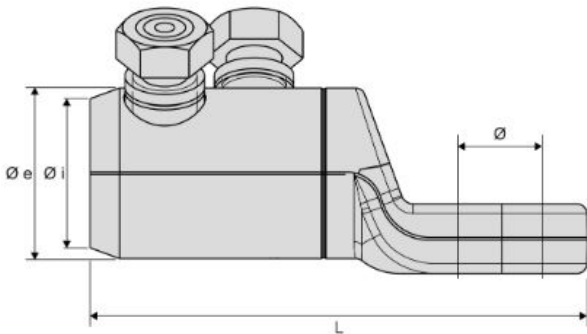

Ref.	Item code	Bolt Ø (mm)	Ø i	Ø e	L	Screw	
						Number	H sur plats (mm)
ML 20/0-8	XXXXXXX	9	10	18	50	1	13
ML20/0-10	XXXXXXX	11	10	18	50	1	13
ML 20/2-16	XXXXXXX	17	15.5	30	80	2	17
ML 20/3-10	XXXXXXX	11	20.8	36	90	2	17
ML 20/3-16	XXXXXXX	17	20.8	36	97	2	17
ML 20/3D-16	XXXXXXX	17	20.8	36	97	2	17
ML 20/3D-12	8969594	13	20.8	36	97	2	17
ML 20/3D1-12	XXXXXXX	13	20.8	36	97	2	17
ML20/3D1-16	XXXXXXX	17	20.8	36	97	2	17
ML 20/3DS-12	XXXXXXX	13	20.8	36	97	2	17
ML 20/3DS-16	XXXXXXX	17	20.8	36	97	2	17
ML 20/3.5-12	XXXXXXX	13	23	38	97	2	22
ML 20/4-12	XXXXXXX	13	23	42	140	3	22



Ref.	Item code	Bolt Ø (mm)	Ø i	Ø e	L	Screw	
						Number	H sur plats (mm)
ML 20/4-18	XXXXXXXX	19	26	42	170	3	22
ML 20/4-20	XXXXXXXX	21	26	42	170	3	22
ML 20/5-12	XXXXXXXX	13	33	50	200	3	22
ML 20/5-16	XXXXXXXX	17	33	50	200	3	22
ML 20/5-18	XXXXXXXX	19	33	50	200	3	22
ML 20/5-20	XXXXXXXX	21	33	50	200	3	22

(\*) Conductor has to be pressed round

